



Technical Bulletin FH 2018-02

First Release:

March 28, 2018

Prepared by:

Remington Brown,
Senior Engineering Director

Applicable Standards:

FORTIFIED Home™–Hurricane

Applicable Designation Level:



Gable End Overhangs and Roof Sheathing Fastening: Re-Roofing to Meet Bronze, New Roof Designation

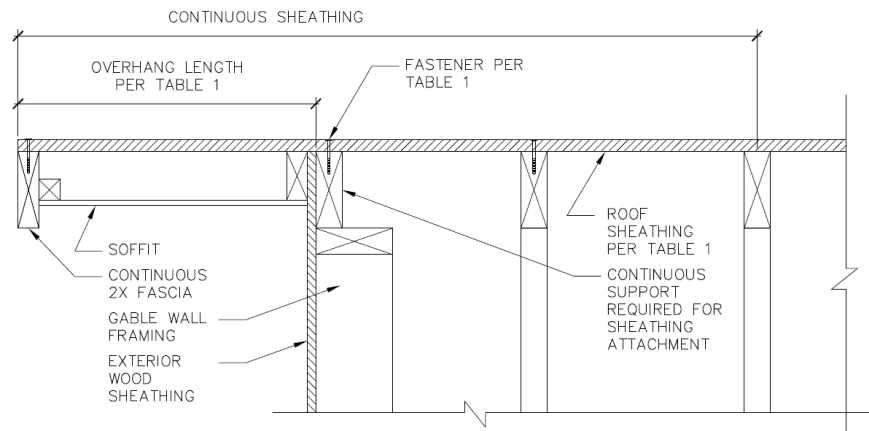

Applicable Conditions

1. Re-roofing projects only.
2. Bronze, new roof designation only. Silver or Gold designations for existing homes with gable overhangs greater than 12 in. require retrofit in accordance with [TB2017-02](#), revised March 21, 2018.

Abstract

Attachment requirements for roof sheathing along the gable end truss or rafter to achieve a FORTIFIED Home™–Hurricane Bronze new roof designation have been enhanced to allow roofers, in most cases, to complete necessary retrofits without having to engage a general contractor. Exceptions, which still require structural modifications by a general contractor, include vented gable rakes and gable ends with overhangs greater than those shown in Table 1 on page 2 of this document.



Technical Bulletin FH 2018-02

First Release:

March 28, 2018

Prepared by:

Remington Brown,
Senior Engineering Director

Applicable Standards:

FORTIFIED Home™–Hurricane

Applicable Designation Level:

BRONZE, New Roof Requirements

Roof sheathing shall be continuously fastened to the top of the gable wall with the minimum fastener size and spacing specified in Table 1 below. These solutions are limited to the maximum overhang length listed in Table 1 and to gable ends with roof sheathing continuously supported by and attached to the gable wall framing.

For gable rake overhangs exceeding the maximum overhang length in Table 1 or for unsupported gable rakes, a professional engineer must develop a building-specific solution.

Table 1. Roof Sheathing Minimum Fastening Requirements at the Gable Truss or Rafter

Roof Sheathing Thickness	Maximum Overhang Length	Attachment
7/16–1/2 in. OSB or plywood	18 in.	8d ring shank nails at 4 in. o.c.
19/32–3/4 in. OSB or plywood	18 in.	10d ring shank nails at 4 in. o.c.
1x6 or narrower planks	24 in.	(2) 10d common nails per plank
1x8 to 1x10 planks	24 in.	(3) 10d common nails per plank

Compliance Verification Requirements

The re-nailing of the deck at all applicable gable end overhangs is to be documented and verified by a certified FORTIFIED evaluator. Acceptable documentation includes but may not be limited to the following:

- Pictures of roof deck nailed in accordance with Table 1.
- Size, type and spacing of the fastener attaching the roof sheathing to the gable end must be listed in the RE-NAILING section of the Roofing Compliance Form.



Completing Evaluation Form (For FORTIFIED Evaluators Only)

In the FOCUS software:

Photos showing roof sheathing attachment at the gable wall that clearly illustrate the fastener spacing conforms to Table 1 requirements must be uploaded by the Evaluator as additional photos in the Roof Deck section of FOCUS under “Roof deck fastener count.”

Roof deck fastener count in 48" location 1

From inside the attic, if adequate access exists, verify roof sheathing is supported at the top of the gable wall. If roof sheathing support at the gable end wall cannot be verified from within the attic, evaluator should select “Partial” under Attic Accessibility, in the Roof Deck portion of the evaluation form. Then describe limited access (e.g., Gable end sheathing support cannot be verified due to limited attic access).

Attic accessibility

If access is Partial or None, describe what restricts access? (Type n/a, if not applicable)

Technical Bulletin FH 2018-02

First Release:

March 28, 2018

Prepared by:

Remington Brown,
Senior Engineering Director

Applicable Standards:

FORTIFIED Home™–Hurricane

Applicable Designation Level:

